

*Proposed Church at Killecooley.*

*February 1823.*

*Transverse Section.*

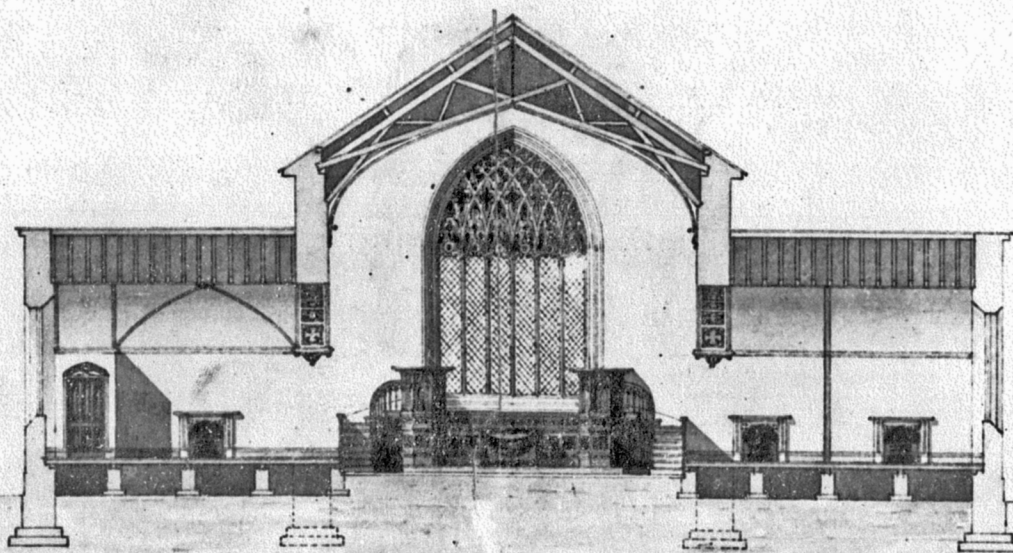

*John Lee Pacher, Architect.*

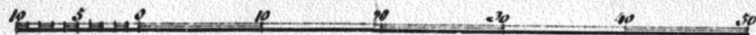

*Colman, Thwaites & Co.*

*Proposed Church at Killcooley.*

*February 1823.*

**GROUND PLAN.**

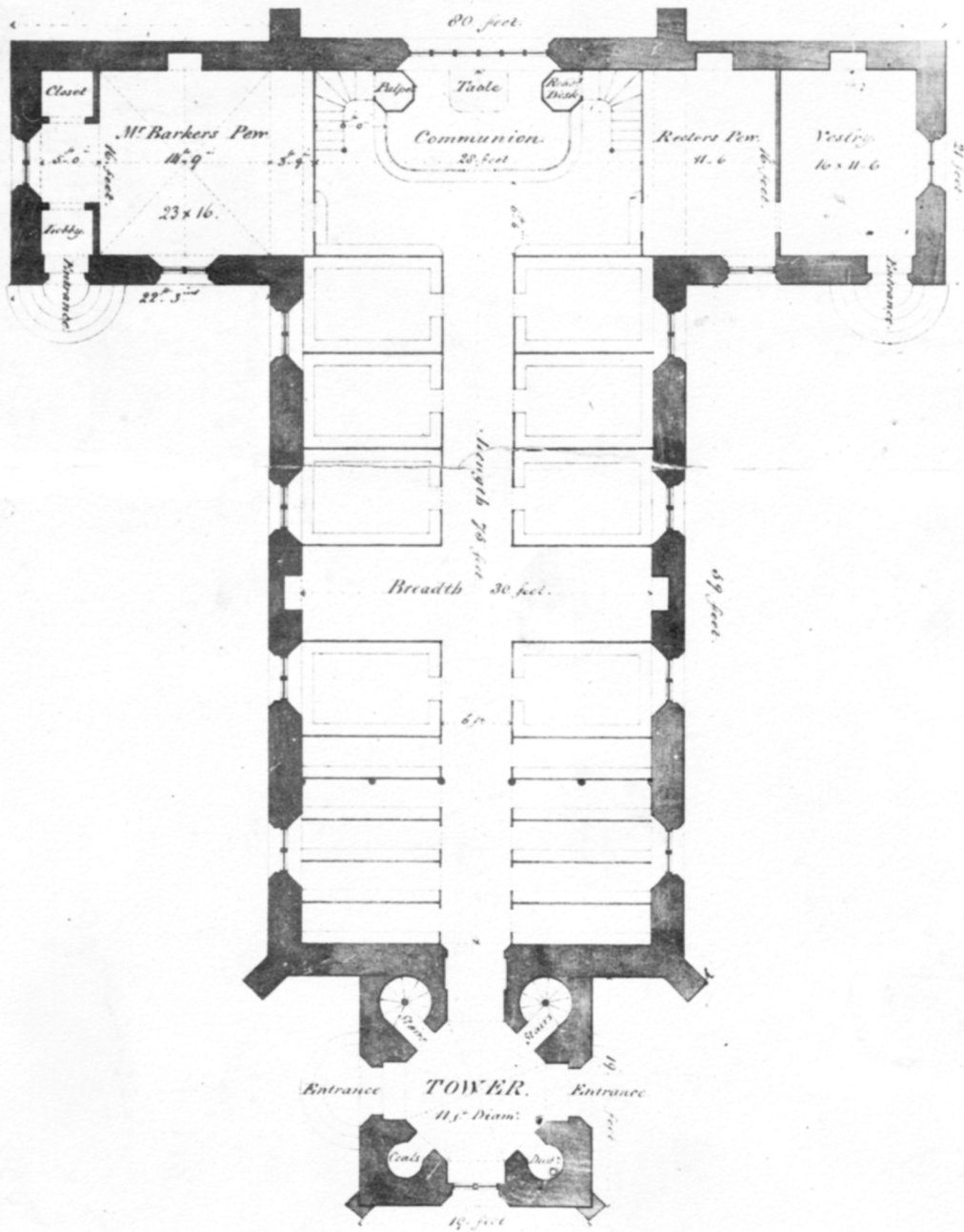

*John Lee Archer, Architect.*

*Richard, Surveyor.*

